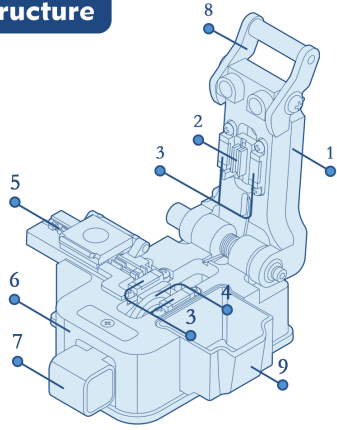

FB-1688C HIGH PRECISION FIBER CLEAVER INSTRUCTION MANUAL

Attention Please Read Me Before Operation

- Please store the product in a dry and clean place at ordinary temperature.
- Don't wet the product, hit it violently, or wipe the rubber pad with alcohol.
- Please clean the dirt on pressure board regularly.
- Constantly clean the collector and ensure no dust and oil dirties inside.

Parameters And Structure

Product Name	FB-1688C Fiber Cleaver	▼ Structure 
Applicable Bare Fiber Diameter	125μm	
Applicable Fiber Core	Singe Core	
Fiber Cutting Length	5~20 mm	
Average Cutting Angle	≤0.5°	
Blade Life	≥48000 Times (1000 Times * 16 Position * 3 Adjustable Height)	
Blade Type	Φ22(mm) H:2(mm)	
Dimension	91W*82D*51H(mm)	
Weight	235g	
Fiber Fixture	5 In 1 Fixture	
Standard	Collector\Instruction Manual\Allen Key	
Packing	PP box(110*120*60mm)	

1. Cover Plate 2. Block 3. Rubber Pad 4. Blade 5. Fiber Fixture
6. Base 7. Slider 8. Pressure bar 9. Collector

Removal Method of Collector

A

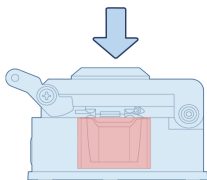

Press the cover down

B

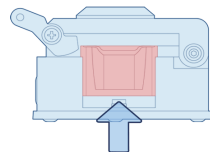

Lift the collector up with a little force, then can easily remove the collector

①

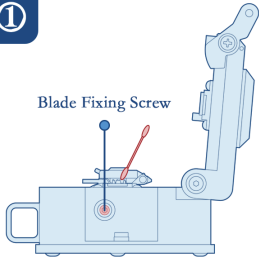

Blade Fixing Screw

②

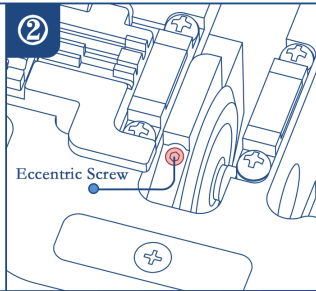

Eccentric Screw

▼ Blade Height Adjustment Method

1. Loosen the **Blade Fixing Screw** with an allen key.
2. Slightly adjust the **Eccentric Screw**, clockwise to lower blade, counterclockwise to lift blade height.
3. Put the fiber which remove coating layer into fixture, press the cover of fixture, push the block back and forth and check if the blade touch the fiber slightly. Adjust the proper position and fix the screw.

▼ Replace Blade

1. Loosen **Blade Fixing Screw**, remove the old blade with the plastic tweezers, install a new blade.
2. Adjust blade height according the method of 'Blade Height Adjusting Method'.

▼ Blade Position Changing Method

1. Use an allen key, loosen the blade fixing screw.
2. Press the blade scale with a cotton swab and turn the blade counterclockwise to a new position.

● Cutting Step

①

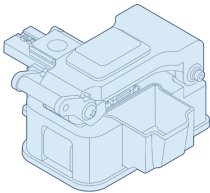

Initial state of the cleaver.

②

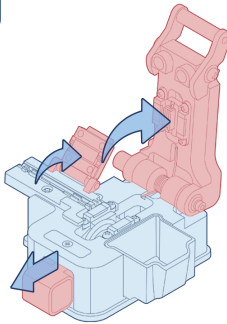

Open the cover plate and fixture cover, the slider will automatic springback.

③

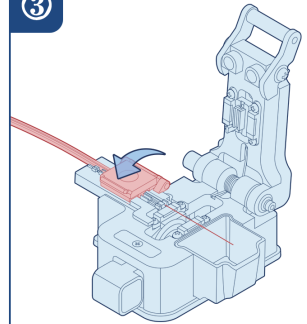

Put the fiber in.

④

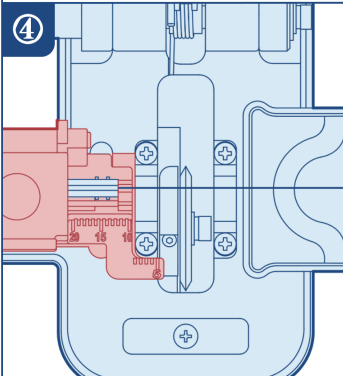

Align the scales and make sure the fiber in horizontal state.

⑤

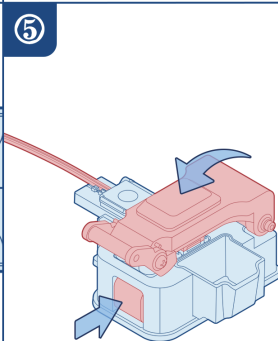

Close the cover and push the block back to complete the cut.

⑥

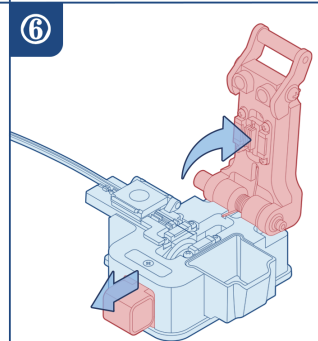

Open the fixture cover, take out the fiber.

FB-1688C高精密光纤切割刀(5合1夹具)带集屑盒

使用说明书

注意 使用前请仔细阅读本说明书

- 请在常温、干燥、洁净处保存。
- 忌弄湿刀身，忌猛烈撞击，忌用酒精擦拭光纤压垫。
- 定期用酒精清洁光纤夹具压纤板上的污垢，切勿用丙酮或有腐蚀性的溶剂清理压纤板。
- 光纤夹具的载纤槽时常清洁，确保槽内无灰尘及污垢。

产品规格与结构

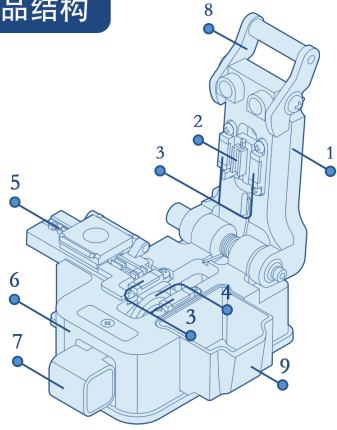
产品型号	FB-1688C光纤切割器	<h4>▼ 产品结构</h4> 
适用裸纤直径	125μm	
适用光纤芯数	单芯	
光纤切割长度	5~20 mm	
切割角度平均值	≤0.5°	
刀片寿命	≥48000次 ※(1000次*16面*3次可调高度)	
刀片规格	Φ22(mm) H:2(mm)	
尺寸	91W*82D*51H(mm)	
重量	235g	
光纤夹具	5合1夹具	
标配	集屑盒 内六角扳手 使用说明书	
包装	PP塑料盒(110*120*60mm)	

- 1.压盖 2.跳件 3.光纤压垫 4.刀片
5.光纤夹具 6.底座 7.推块 8.压杆 9.集屑盒

集屑盒拆卸方法

A

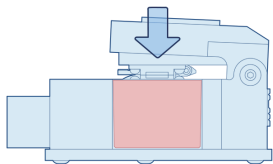

先向下按住压盖

B

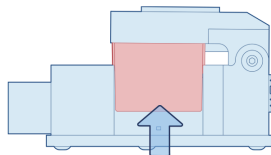

再稍稍用力将收纤盒往上提 即可轻松取下集屑盒

①

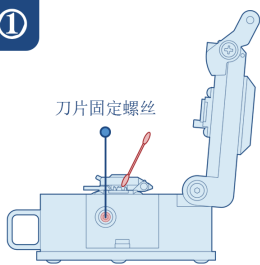

▼刀片换面方法

1. 使用内六角扳手，松开刀片固定螺丝。
2. 用棉棒按着刀刃，将刀片向逆时针方向旋转到新的刻度。

②

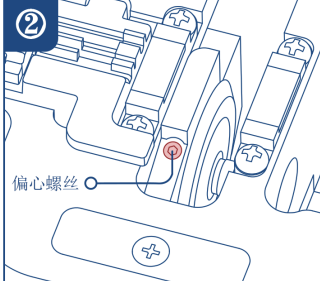

▼刀片高度调节方法

1. 使用内六角扳手，松开刀片固定螺丝。
2. 微调偏心螺丝，顺时针方向为降低刀片，逆时针为升高刀片高度。
3. 将剥除好涂覆层的裸光纤放置于夹具内，合上夹具压盖，来回推动推块，观察刀刃是否轻轻触碰到光纤，调整到合适位置，并固定螺丝。

▼更换刀片

1. 松开刀片固定螺丝，用塑料镊子取出旧刀片，更换新刀片。
2. 根据刀片高度调节方法调整刀片高度。

● 切割步骤

①

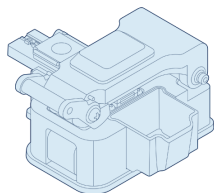

切割器初始状态

②

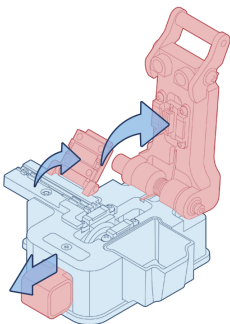

开启压盖和夹具盖 自动弹出

③

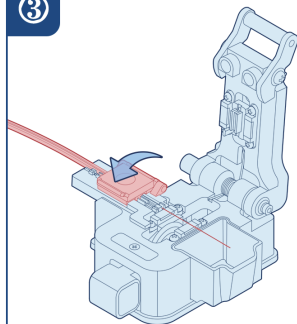

放入光纤

④

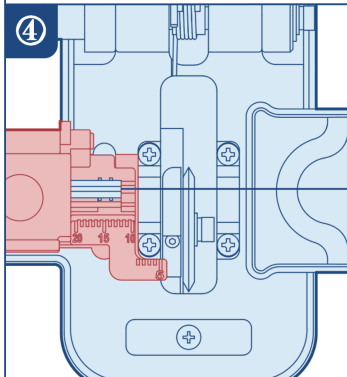

对齐刻度并确保光纤处于水平

⑤

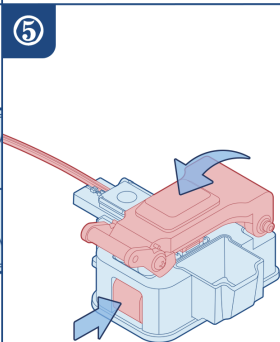

合上压盖 推块向后推完成切割

⑥

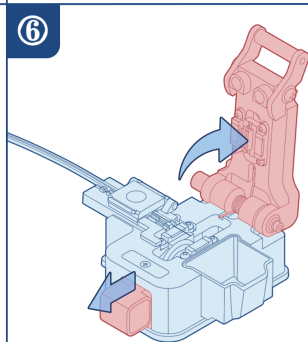

开启压盖 取出光纤