

Packing List:

- | | Qty |
|--|------------|
| 1. INDEXA Precision Toolmaker's Vice | 1 |
| 2. Hex. Key. - 6mm | 1 |
| 3. Instructions/Quality Certificate/Packing List | 1 |

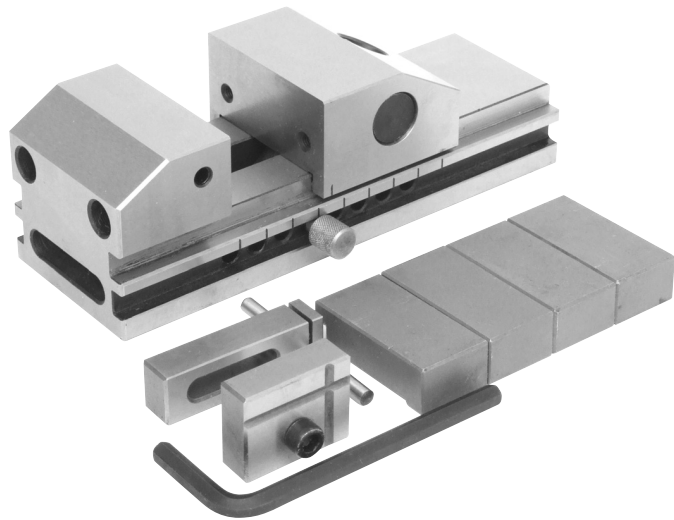

INDEXA Machine Tools, Wigston, Leicester, England



Certificate of Quality

This Vice has been tested and approved for sale

Type TVP060

Type TVP075

Inspector:

Date:



Instructions for Precision Toolmaker's Vice

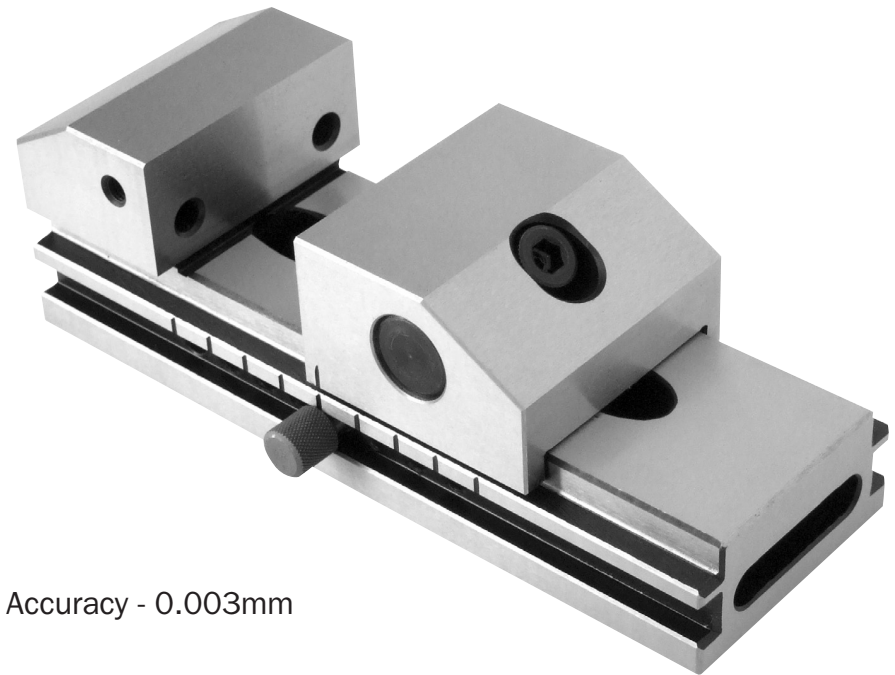

Accuracy - 0.003mm

Model	ORDER CODE
TVP060	IND-445-0200K
TVP075	IND-445-0210K

Always read instructions before use!

INDEXA Precision Toolmaker's Vices are produced using the finest quality Alloy Steel, machined to give a smooth surface before hardening for durability. The Vice has a quick release mechanism with a high clamping force making it ideal for measurement and inspection.

Main Technical Specifications

MODEL	Jaw width	Jaw Depth	Spread	Length	Weight
TVP060	60	28	80	175	3.9kg
TVP075	75	40	100	220	7.9kg

Components:

1. Body
2. Moveable Jaw
3. Jaw Adjusting Arm
4. Jaw Adjusting Pin
5. Clamping Inserts
6. M6 Socket Head Cap Screw
7. Clamping Spindle
8. Hex Key - 6mm

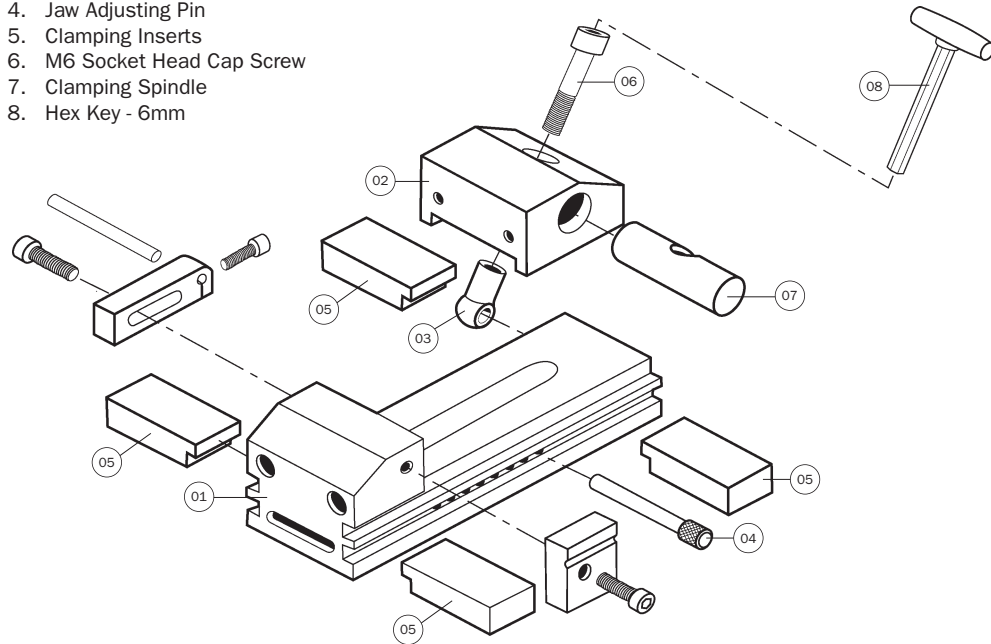

Note: This is a Precision Vice. To ensure the best results, the work table accuracy should be within 0.005mm.

Instructions:

1. Choose the correct size vice for the intended workpiece and locate it on the table, fixing with clamping inserts.
2. Release the Jaw 02, by loosening Socket Head Cap Screw 06.
3. Move Jaw 02 to the correct position for the size of work being undertaken. (locating the Jaw Adjusting Pin 04 in the correct hole).
4. Tighten the Socket Head Cap Screw 06 onto the Clamping Spindle 07 which tightens the Moveable Jaw 02, clamping the workpiece.

Maintenance

All parts should be lubricated regularly. If the Vice is to be stored for a long time, all parts must be cleaned, coated with oil and packed in plastic bags.

Inspection Checklist

Check	Diagramatic	Tolerance (mm)	Result
1 Parallelism of the upper body surface of the guide way to the base surface		0.003/100mm	
2 Squareness of the fixed jaw face and moveable jaw face to the base surface		0.003/100mm	
3 Parallelism of the two jaws in the width direction		0.003/100mm	
4 Squareness of the end face of the body to the base surface		0.003/100mm	
5 Squareness of the two sides of the body to the base surface		0.003/100mm	
6 Squareness of the body end face to the sides		0.003/100mm	
7 Parallelism of the two sides of the body in the length direction		0.003/100mm	